

ATLANTIS
RAIL SYSTEMS

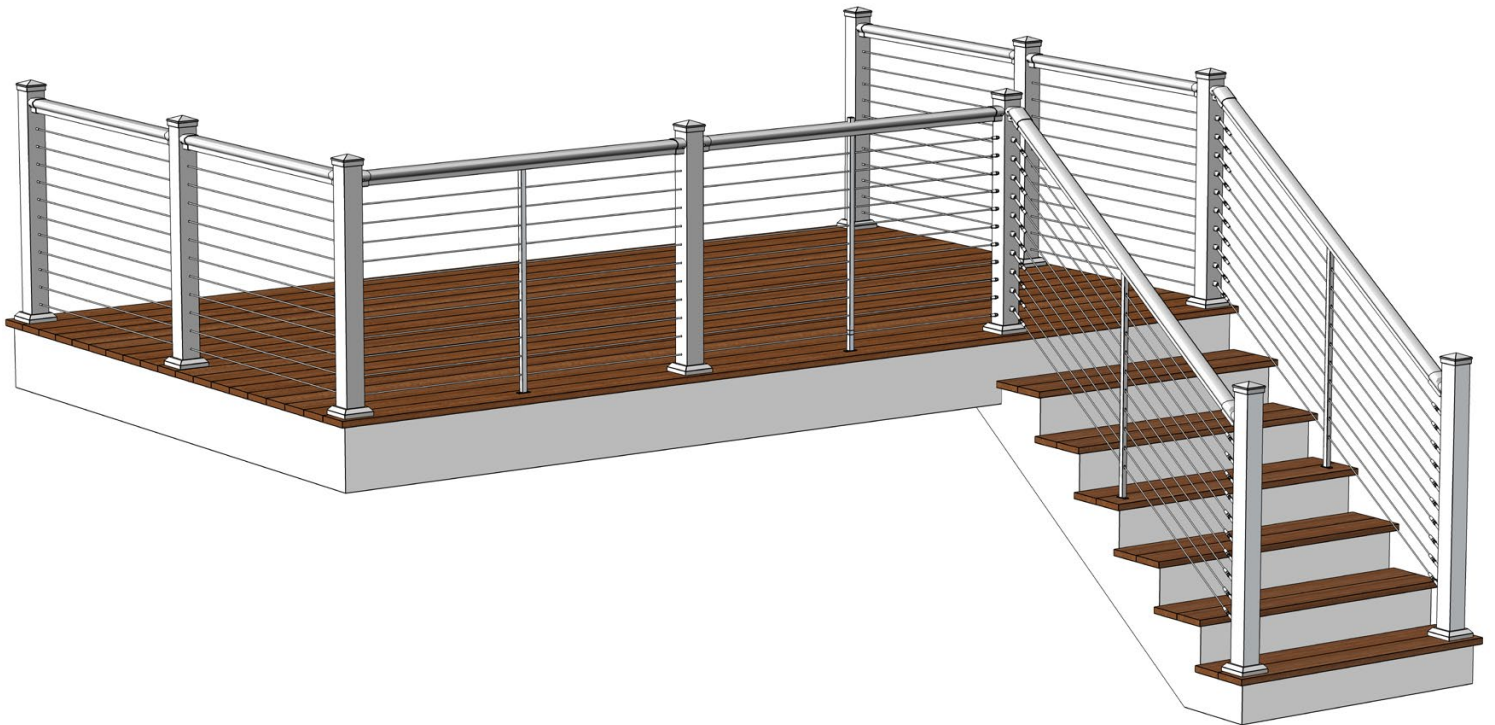

NOVA I

Modular Aluminum Railing System

Revision 1

NOVA Combines the Ease of Modular Kits with the Beauty of Cable Railing

The NOVA I System features powder-coated aluminum posts, guardrails, and horizontal cable infill. The cable infill utilizes HandiSwage™ fittings with 1/8" cable. This system is completely off-the-shelf and features minimal components. Each post and rail kit includes everything needed for installation. Post mounting hardware, cable and cable mounting hardware are sold separately.

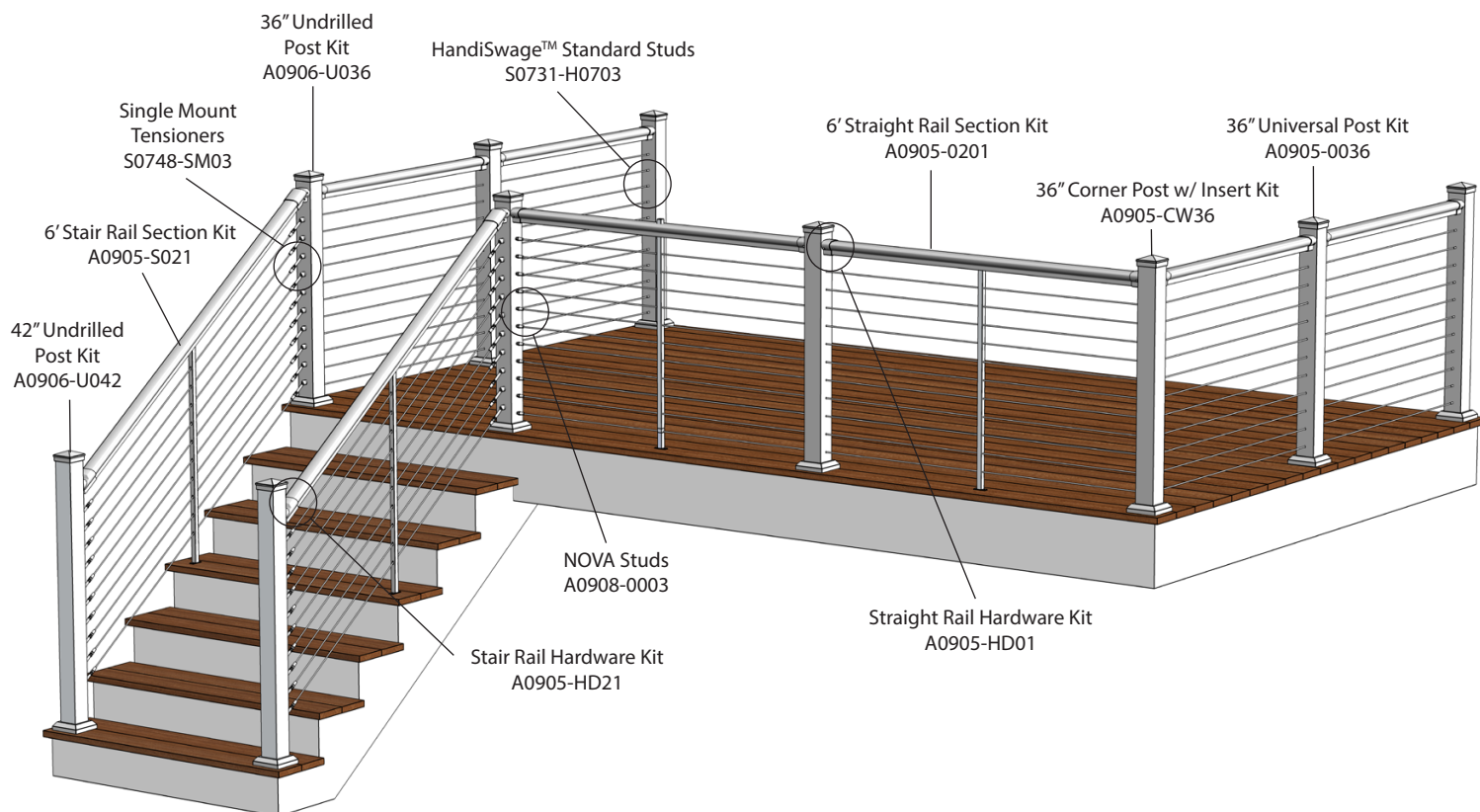

Standard Colors



Black



White



Bronze

Standard Color Options:

Black (-BK), White (-WT),
Bronze (-BZ)

Powder Coat Finish: Matte/Textured



Touch Up Paint, 6 oz.

Black (A0906-P052-BK)
Bronze (A0906-P052-BZ)
White (A0906-P052-WH)

Use NOVA touch-up paint to fix any scratches which may occur to the powder coat finish during the installation process.

LEVEL SECTION



For straight rails on level sections, use the NOVA 6' Straight Rail Section Kits. Each kit consists of a top rail, as well as a cable stabilizer for added support.

NOVA I 6' Straight Rail Section Kit (A0905-0201-*XX)

ITEM	DESCRIPTION	QTY
1	NOVA Top Rail	1
2	Stabilizer, 36" Drilled	1
3	Pan Head Screw, #10 x 1"	2
4	Mounting Plate	1
5	Nylon Gasket	1
6	Flat Head Screw, #12 x 1"	1
7	Nylon Washer	2
8	Plastic Connector	2
9	Self-Drill Screw, #8 x 3/4"	1

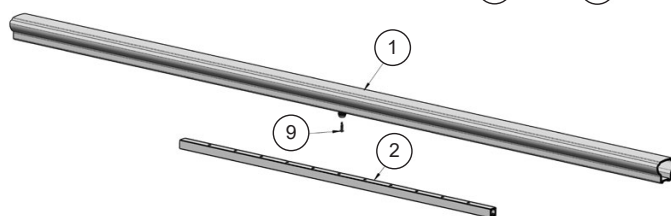
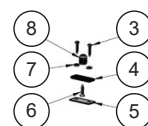

STAIR SECTION

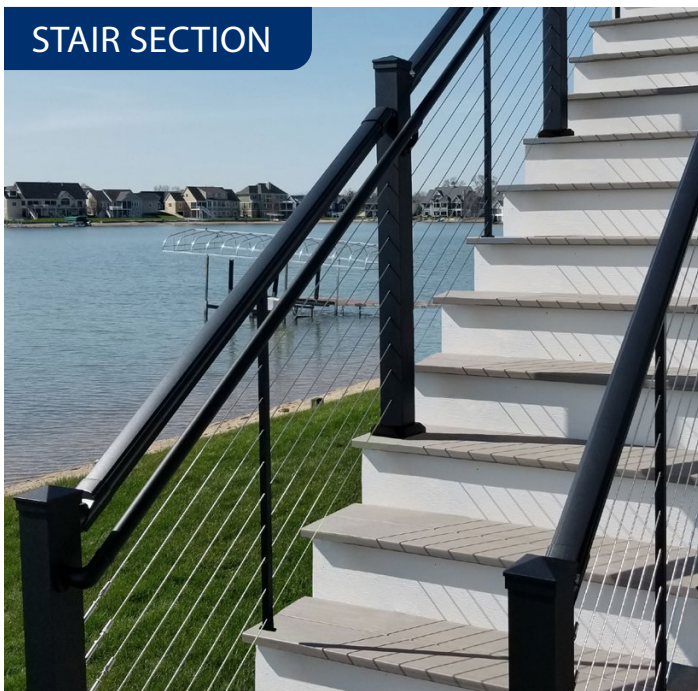

For stair rails on stair sections, use the NOVA 6' Stair Rail Section Kits. Each kit consists of a top rail, as well as a cable stabilizer for added support. The NOVA system accommodates stair angles ranging from 29 to 41 degrees.

NOVA I 6' Stair Rail Section Kit (A0905-S021-*XX)

ITEM	DESCRIPTION	QTY
1	NOVA Top Rail	1
2	Stabilizer, Slotted	1
3	Pan Head Screw, #10 x 1"	2
4	Mounting Plate	1
5	Nylon Gasket	1
6	Flat Head Screw, #12 x 1"	1
7	Nylon Washer	2
8	Plastic Connector	1
9	Self-Drill Screw, #8 x 3/4"	1
10	Plastic Connector, Angled	1

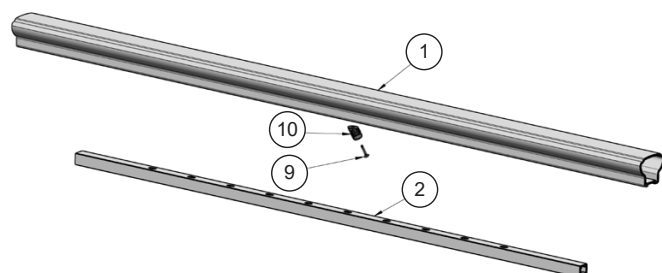
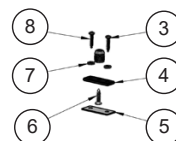

LEVEL SECTION

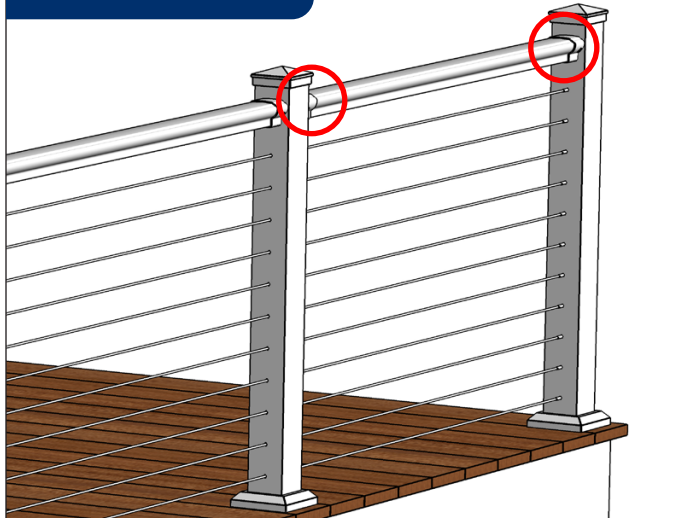

NOVA I Straight Rail Section Hardware Kit (A0905-HD01-*XX)

This hardware kit is essential for attaching the straight rail kits to the posts on level sections. The top rail brackets are female to conceal cut edges of rail. The supplied mounting screws and covers provide a secure and clean looking finished product. Includes a square driver bit for your convenience.

ITEM	DESCRIPTION	QTY
1	Top Rail Bracket	2
2	Top Rail Bracket Key	2
3	Top Rail Bracket Screw Cover	4
4	Self-Drill Screw	6
5	Button Head Cap Screw	4
6	Square Drive Bit	1

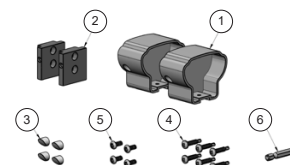

STAIR SECTION

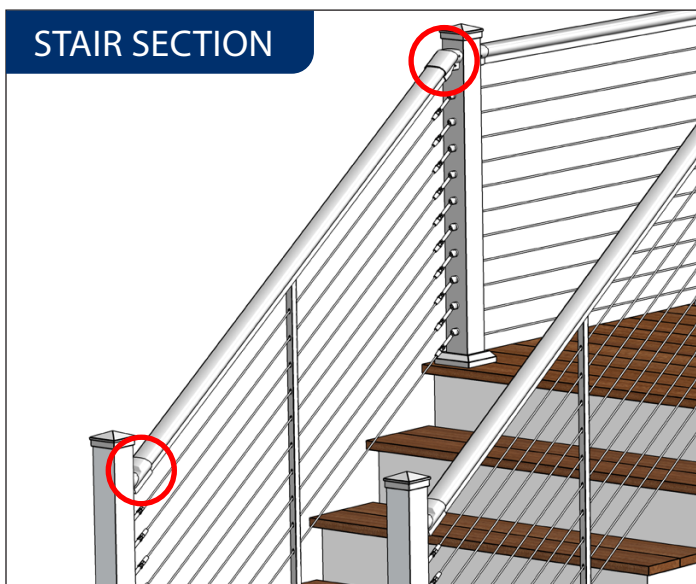

NOVA I Stair Rail Section Hardware Kit (A0905-HD21-*XX)

This hardware kit is for attaching the stair rail kits to the posts on stair sections. The top rail brackets are female to conceal cut edges of rail. The supplied mounting screws and covers provide a secure and clean looking finished product. Includes a square driver bit and drilling templates for marking mounting hole locations.

ITEM	DESCRIPTION	QTY
1	Top Rail Bracket Mount	2
2	Top Rail Upper Bracket	1
3	Rail Lower Bracket	1
4	Screw Cover	4
5	Self-Drill Screw	6
6	Set Screw	4
7	Allen Key	1
8	Square Drive Bit	1
9	Templates (set of 4)	1

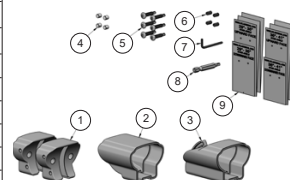

ANGLES

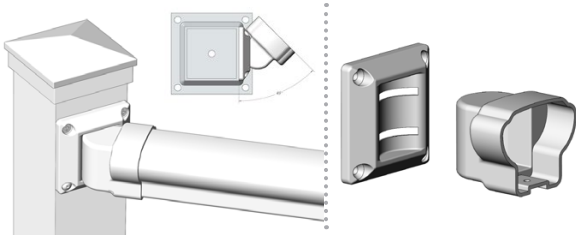

NOVA I Adjustable Angle Hardware Kit (A0905-0075-*XX)

To accommodate railing sections that are at an angle of 45 degrees or less to the straight sections on your level deck surface, use the Adjustable Rail Bracket Kit. Each kit includes (1) top rail bracket with the necessary mounting hardware.

RAMPS

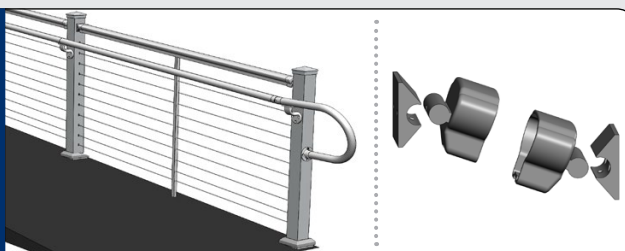

NOVA I Pivoting Fitting Hardware Kit (A0905-0031-*XX)

The Pivoting Fittings are a universal stair and/or ramp bracket set that can accommodate all angles up to 45 degrees. Each kit includes (2) top rail brackets with the necessary mounting hardware. Drilling templates available for stair and ramp applications.

Post Kits

NOVA I

MID/END POSTS

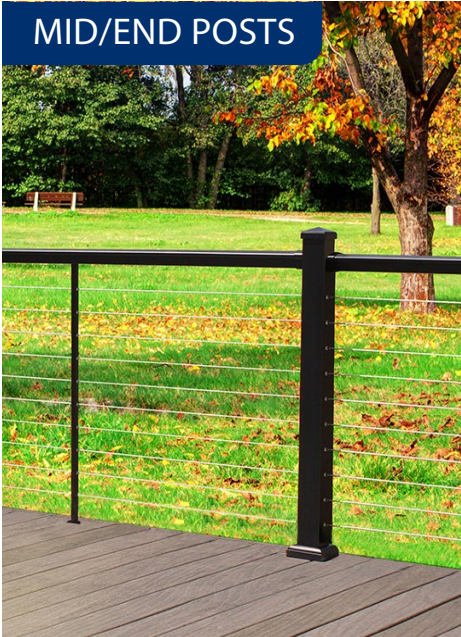

NOVA Universal Posts are used as mid and end posts. They are pre-drilled on two sides to allow cable and fittings to pass through. The holes are spaced properly for code compliancy. Post mounting hardware is NOT included!

NOVA I 36" Universal Post Kit (A0905-0036-*XX)

ITEM	DESCRIPTION	QTY
1	36" Post, Drilled	1
2	Post Cap	1
3	Post Skirt	1
4	Post Pad	1

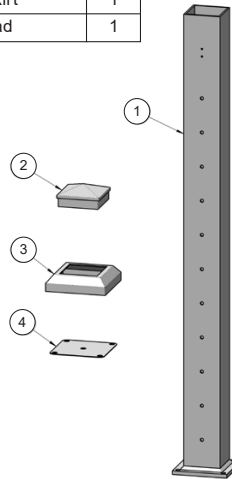

NOVA I 42" Universal Post Kit (A0905-0042-*XX)

ITEM	DESCRIPTION	QTY
1	42" Post, Drilled	1
2	Post Cap	1
3	Post Skirt	1
4	Post Pad	1

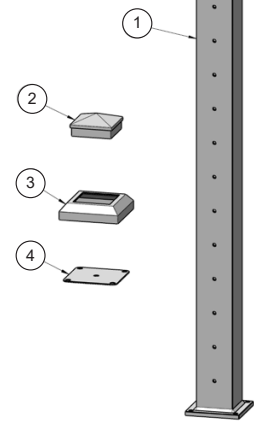

CORNER POSTS



NOVA Corner Posts are used where two rail sections meet at 90 degrees. These posts are drilled on three sides. The pre-drilled opposing sides allow cable studs to pass through, and the remaining side is drilled and threaded to accept the 1/4" thread found on the NOVA Studs included in the kit. The NOVA Studs are used as a fixed end fitting. The holes are spaced properly for code compliancy. Post mounting hardware is NOT included!

NOVA I 36" Corner Post Kit (A0905-C036-*XX)

ITEM	DESCRIPTION	QTY
1	36" Corner Post, Drilled	1
2	Post Cap	1
3	Post Skirt	1
4	Post Pad	1
5	NOVA Studs	11
6	Plastic Washers	11
7	Cable Grommets	11

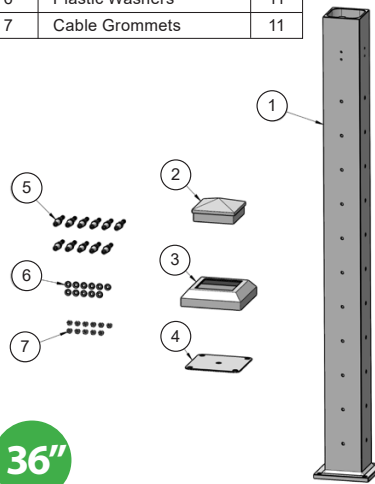

NOVA I 42" Corner Post Kit (A0905-C042-*XX)

ITEM	DESCRIPTION	QTY
1	42" Corner Post, Drilled	1
2	Post Cap	1
3	Post Skirt	1
4	Post Pad	1
5	NOVA Studs	13
6	Plastic Washers	13
7	Cable Grommets	13

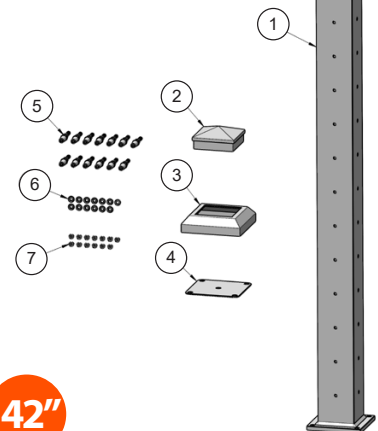

PASS-THROUGH CORNER

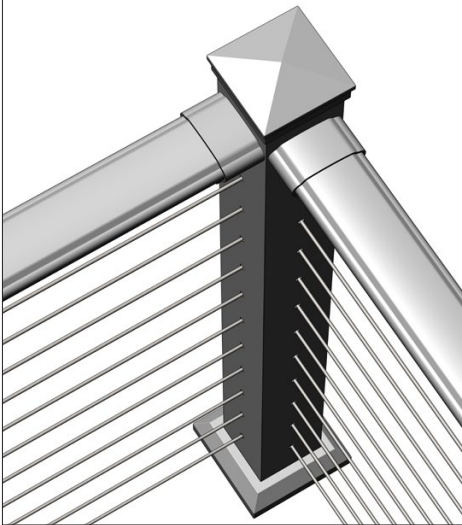

NOVA Corner Posts w/ Insert are used where two rail sections meet at 90 degrees. These posts are pre-drilled to allow cable to pass through eliminating the need for fittings. The holes are spaced properly for code compliance. The rounded insert allows the cable to be tensioned without making contact with sharp edges. Post mounting hardware is NOT included!

NOVA I 36" Corner Post w/ Insert Kit (A0905-CW36-*XX)

ITEM	DESCRIPTION	QTY
1	36" Corner Post, Drilled	1
2	Post Cap	1
3	Post Skirt	1
4	Post Pad	1
5	Corner Post Insert	1

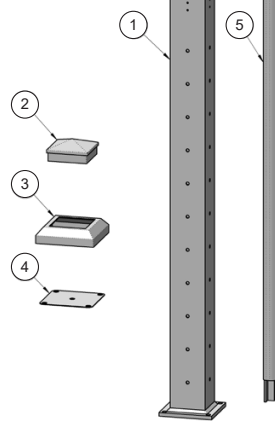

NOVA I 42" Corner Post w/ Insert Kit (A0905-CW42-*XX)

ITEM	DESCRIPTION	QTY
1	42" Corner Post, Drilled	1
2	Post Cap	1
3	Post Skirt	1
4	Post Pad	1
5	Corner Post Insert	1

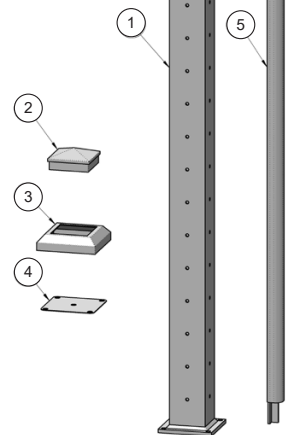

MULTI-USE

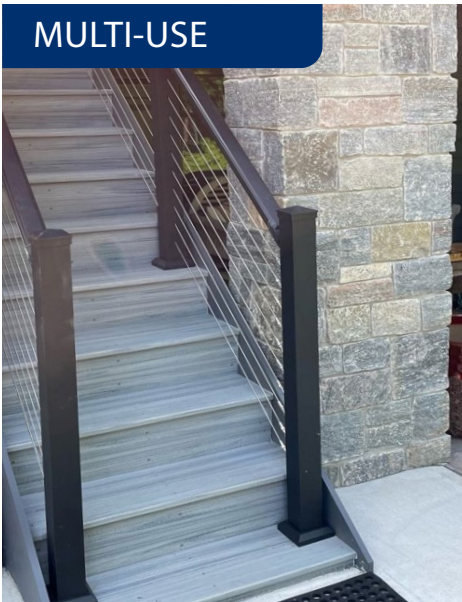

NOVA Undrilled Posts are typically used at the top and bottom of stair sections, but can be used elsewhere in a project for non-typical scenarios. If used on stairs, the drilling templates included in the stair rail hardware kits would be used to predrill mounting holes for brackets and tensioners. Post mounting hardware is NOT included!

NOVA 36" Undrilled Post Kit (A0906-U036-*XX)

ITEM	DESCRIPTION	QTY
1	36" Post, Undrilled	1
2	Post Skirt	1
3	Post Cap	1
4	Post Pad	1

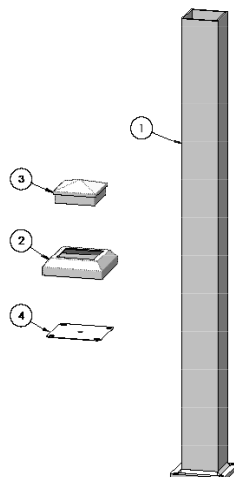

NOVA 42" Undrilled Post Kit (A0906-U042-*XX)

ITEM	DESCRIPTION	QTY
1	42" Post, Undrilled	1
2	Post Skirt	1
3	Post Cap	1
4	Post Pad	1

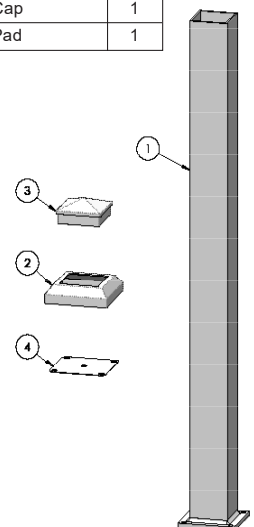

Post Kits

NOVA I

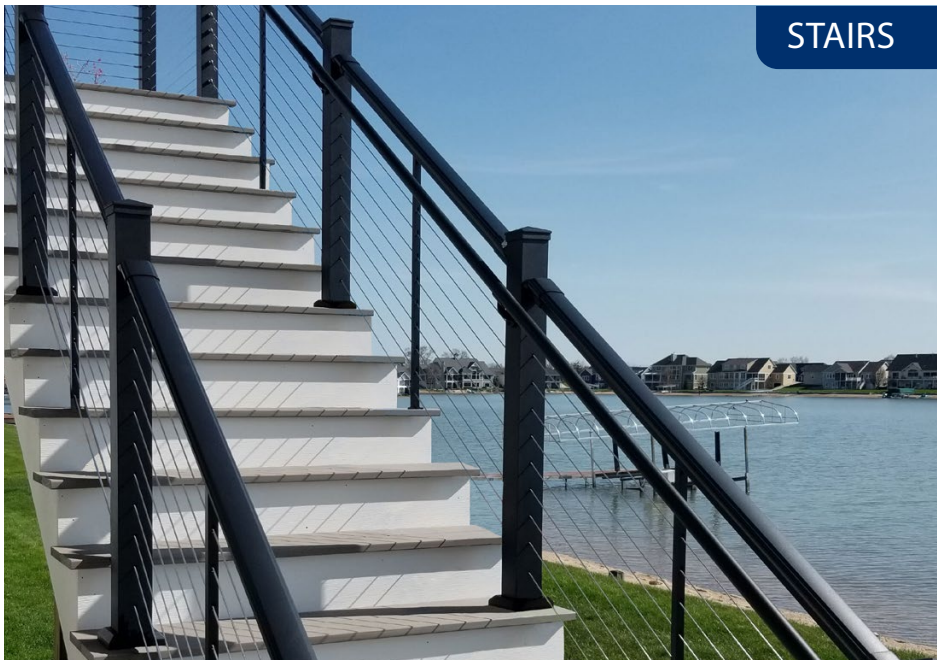

STAIRS

NOVA I 42" Stair Mid Post Kit (A0905-SM42-*XX)

ITEM	DESCRIPTION	QTY
1	42" Post, Slotted	1
2	Post Cap	1
3	Post Skirt	1
4	Post Pad	1

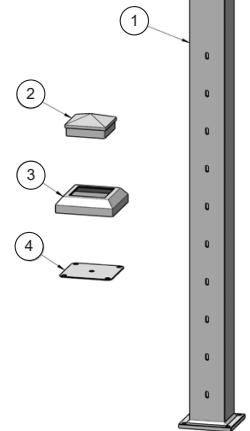

NOVA Stair Mid Posts are slotted on two sides to allow cable to pass through while matching the angle of the stairs (29 to 41 Degrees). Slots are spaced properly to meet code compliancy. The drilling templates included in the stair rail hardware kits are used on each mid post to predrill mounting holes for the stair rail brackets. Post mounting hardware is NOT included!

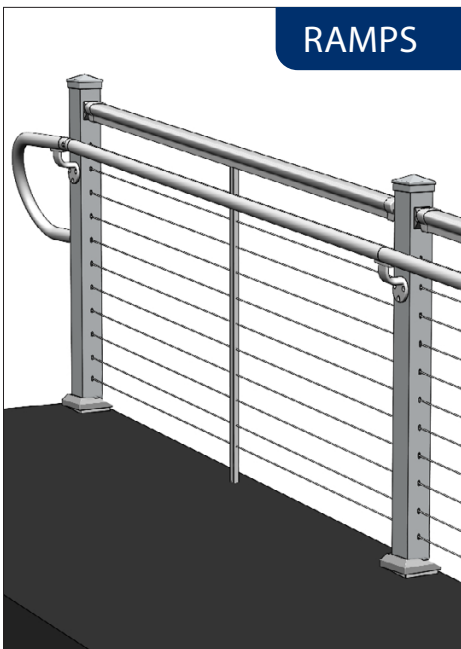

RAMPS

NOVA I 36" ADA Ramp Post Kit (A0905-ADA36-*XX)

ITEM	DESCRIPTION	QTY
1	36" Post, Slotted	1
2	Post Cap	1
3	Post Skirt	1
4	Post-Ramp Adapter	1
5	Post Pad	1

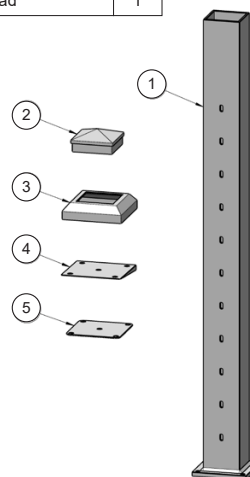

NOVA I 42" ADA Ramp Post Kit (A0905-ADA42-*XX)

ITEM	DESCRIPTION	QTY
1	42" Post, Slotted	1
2	Post Cap	1
3	Post Skirt	1
4	Post-Ramp Adapter	1
5	Post Pad	1

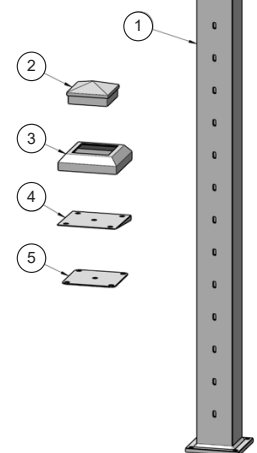

NOVA ADA Ramp Posts are slotted on two sides to allow cable and fittings to pass through while matching the angle of the ramp (typically 5 Degrees). Post-ramp adapter included to mount post to sloped surface while keeping it plumb. Post mounting hardware is NOT included!

36"

ITEM	DESCRIPTION	QTY
1	36" Gate, Drilled for Cable	1
2	Latch, "Key Lock" Assembly	1
3	Hinge, Self-Closing	2
4	Mounting Hardware	12

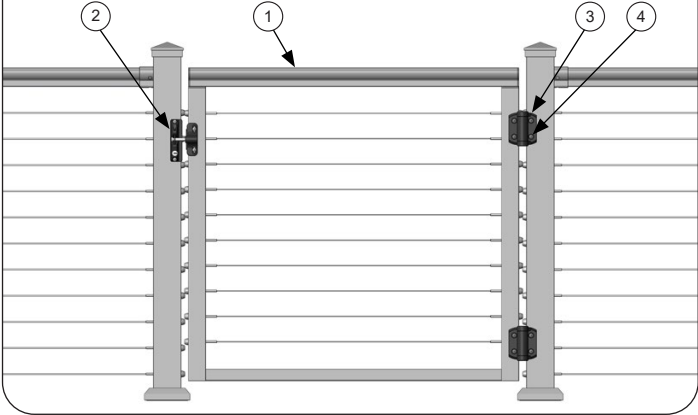

42"

ITEM	DESCRIPTION	QTY
1	42" Gate, Drilled for Cable	1
2	Latch, "Key Lock" Assembly	1
3	Hinge, Self-Closing	2
4	Mounting Hardware	12

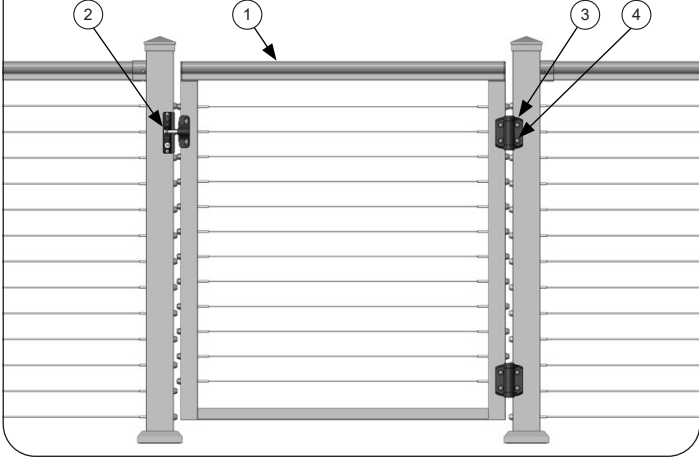

NOVA 36" Gate Kit
(A0906-G036-XX)

NOVA 42" Gate Kit
(A0906-G042-XX)

NOVA Gate Kits are designed to be easily integrated into NOVA I rail systems, while maintaining a consistent look throughout. The strong, yet light weight framework is powdercoated and predrilled with holes spaced properly for code compliancy. The gate does NOT come with cable already installed. It is on the end user to install the gate's cable infill. Each all inclusive gate kit comes with hinges, latch, mounting hardware, cable and fittings.

COMPONENTS for NOVA GATE

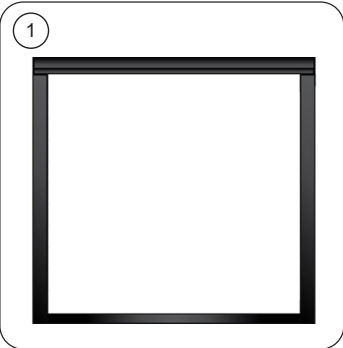

NOVA Gate Frame



NOVA Gate Locking Latch



NOVA Gate Hinges



#10 x 1 Self Drilling Screws

CABLE INFILL for NOVA GATE

Gates are NOT pre-strung with cable! End user must install cable infill.





CABLE



The NOVA System utilizes HandiSwage™ fittings and 1/8" cable. HandiSwage™ fittings are crimped onto cable using our specially designed hand swage tools. It is an easy to install and economical solution for cable railing.

Easy Installation

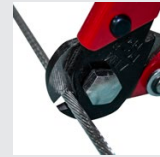

Cut

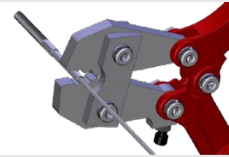

Crimp

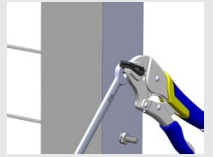

Tension



HandiSwage™ Cable, 100 ft. (S0701-0003-01)

This cable features a 1×19 construction and is available in a 1/8" diameter. The cable is left hand lay and made from grade 316L stainless steel for maximum corrosion resistance and durability. 100 ft. supplied on a spool.



HandiSwage™ Cable, 250 ft. (S0701-0003-02)

This cable features a 1×19 construction and is available in a 1/8" diameter. The cable is left hand lay and made from grade 316L stainless steel for maximum corrosion resistance and durability. 250 ft. supplied on a spool.

CABLE FITTINGS

For more information see the
HandiSwage™ Detailed Overview Catalog



HandiSwage™ Standard Stud 2 Pack (C0731-H0703-2) 10 Pack (C0731-H0703-10)

Made from grade 316L stainless steel for maximum corrosion resistance. 1/4" UNF threaded. Designed to crimp onto 1/8" cable. For hand swage use only.

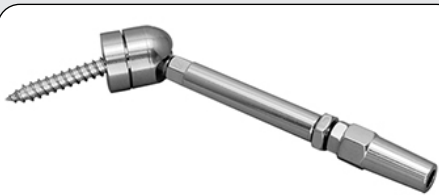

Single Mount Tensioner 2 Pack (C0748-SM03-2)

Made from grade 316L stainless steel and designed to accommodate angles up to 45 degrees. Designed for tensioning 1/8" cable. Mechanically attaches to cable using simple hand tools. Fastener included.



NOVA Studs (A0908-0003)

Supplied with NOVA "C0" Corner Posts, these studs thread into the posts and mechanically attach to 1/8" cable using simple hand tools. Used as a fixed end termination. Made from grade 316L stainless steel for durability.

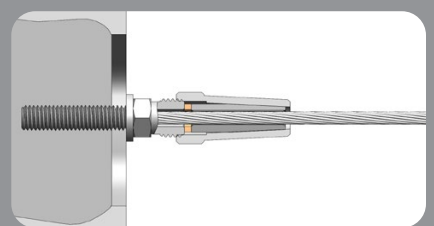
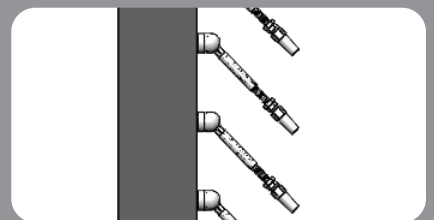
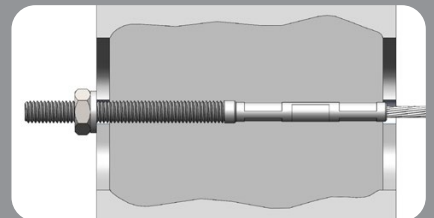



Cable Railing Basics

REGARDLESS OF WHAT ATLANTIS CABLE RAILING YOU USE, WE WANT TO MAKE SURE YOU INSTALL YOUR CABLE RAILING TO A SAFE AND CODE COMPLIANT SPECIFICATION.

To start planning your project always make sure you check with your local code compliance official before starting your cable railing project. They may have special requirements.

The first three basics of cable railing involve spacing; cable spacing, post spacing and total area covered (length of runs).

WE DEFINE THESE SPECIFICATIONS AS THE RULE OF 3, 4, 5.

- 3** Cable spacing must **NEVER EXCEED 3 INCHES**.
- 4** Distance between post can **NEVER EXCEED 4 FEET**, if it is necessary to have post spacing over 4 ft., always add cable stabilizers.
- 5** Cable runs should **NOT EXCEED 50 FEET** in total length.

OTHER MUST HAVE / MUST DO CRITERIA AND SPECIFICATIONS FOR CABLE RAILING

- You must always use a top rail.
- You must make sure your structure offers proper blocking where posts are mounted per your local building codes.
- You must follow the manufacturer's instructions including cleaning and maintenance. Stainless steel is "low" maintenance, not "no" maintenance.

LED LIGHTING



Add LED Accent Lighting to your NOVA rail system with MicroStar™ Light Bars!

MicroStar™ LED Light Bars can be added to your NOVA rail system to provide accent lighting and ambiance. Light Bars surface mount to the underside of the top rail delivering significant downlighting. The hue of the lights can be described as bright white/daylight. The light bars are connected using a series of water-resistant jumpers and rubber grommets for a clean install. The MicroStar™ Transformer (DC) powers the lighting system and is UL approved.

**For more information see the
MicroStar™ Lighting Detailed Overview Catalog**

ADA HANDRAIL



Make your NOVA rail system ADA compliant with our surface mount handrail.

Atlantis offers a full line of surface mount supports and handrail to make your NOVA rail system ADA compliant. The simple design allows installers to handle a variety of handrail transitions using a small set of components. The handrail system is made from aluminum and is powdercoated for a durable finish. Offered in standard NOVA color options.

**For more information see the
ADA Handrail Detailed Overview Catalog**



HandiSwage™ Hand Swager (E0113-H600)

This swager crimps hand swage studs onto 1/8", 5/32" and 3/16" cable. After Swage Gauge included to confirm proper swaging. For use with HandiSwage™ Series ONLY.



HandiSwage™ Bench Swager (E0115-H600)

This swager crimps hand swage studs onto 1/8", 5/32" and 3/16" cable. After Swage Gauge included to confirm proper swaging. For use with HandiSwage™ Series ONLY.



RailEasy™ Cable Cutter (C0989-00HD)

This cutter features heat treated blades which cleanly cut up to 5/32" diameter cable.



HandiSwage™ Combo Wrench Set (C0731-TK01-2)

This set consists of (2) 3/8" & 7/16" combination wrenches. These are used to tension studs and install cover nut sets.



Cover Nut Set, 10 Packs

Black (C0309-BK02-10)
Dark Brown (C0309-BR02-10)
White (C0309-WH02-10)

These sets are used to tension HandiSwage™ Studs and cover hardware for a finished look.



Cable Grip Pad, 3 Pack (E0114-0000)

This neoprene pad is used between vice grips and cable during the tensioning process to prevent damage to the cable.



Cutting Disk, 2 Pack (E0113-CD04-2)

Cutting disk used to cut threads on HandiSwage™ studs after installation. Not recommended for cutting cable. For cutting metal only. Never exceed Max RPM of 13,300.

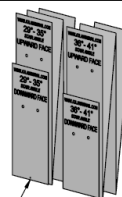

Drilling Template Set (A0905-TMP01)

Supplied with the Stair Rail Hardware Kit to assist in marking and drilling mounting holes in stair posts for rail brackets and tensioner installation.



Post Mounting Hardware (A0908-HD10)

This hardware kit is used to surface mount NOVA posts to wood structures. Kit includes (4) 5/16" x 4-1/2" stainless steel hex lag bolts and accompanying cover nuts.

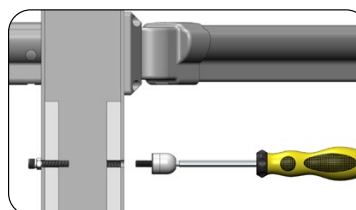

Threaded Post Insert 36" (A0905-C036-INSERT) 42" (A0905-C042-INSERT)

This insert provides flexibility in design by offering a way to attach threaded fittings and fasteners to posts. Hole spacing matches hole spacing on posts.

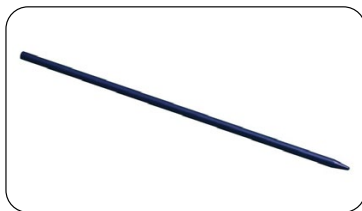

Straight Lacing Needle, 2 Pack

(C0988-4000-2)

Use the Cable Lacing Needle with 1/8" and 5/32" cable. It helps guide cable through post holes without snagging to ensure a quick and easy cable railing installation.

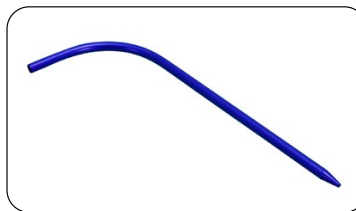

Curved Lacing Needle, 2 Pack

(C0988-400C-2)

Use this lacing needle to feed cable through the NOVA "CW" Corner Post with Inserts. Makes passing cable through adjacent post faces easy.



Cable Grommet, 25 Pack

Mid Post (C0916-0003-25)
End Post (C0916-B003-25)
Stabilizer (C0916-A003-25)

These plastic grommets make installation clean looking while preventing contact between stainless components and aluminum posts.

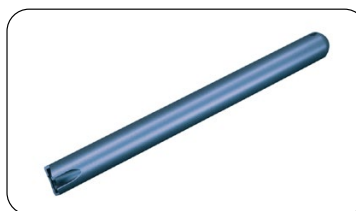

Cable Grommet Install Tool

(E0916-1000)

This simple tool makes installing cable grommets quick and easy. Designed to clip grommet onto cable and push them into post holes.



MicroStar™ Transformer

(S0832-0005)

DC transformer used to power the optional MicroStar™ LED Light Bars on NOVA rail systems. Heavy duty, water resistant construction. UL approved.



Wire Harness Grommet, 10 Pack

(S0825-GR1203-10)

These rubber grommets are installed into the holes used for wiring the MicroStar™ LED Light Bars on NOVA. Protects wiring from sharp edges.

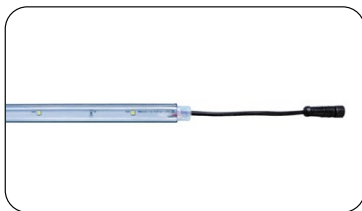

MicroStar™ LED Light Bar

18" (S0825-0018-XX*)
30" (S0825-0030-XX*)
42" (S0825-0042-XX*)

LED accent lighting that can be surface mounted on the underside of top rail on NOVA.



Touch Up Paint, 6 oz.

Black (A0906-P052-BK)
Bronze (A0906-P052-BZ)
White (A0906-P052-WH)

Use NOVA touch-up paint to fix any scratches which may occur to the powder coat finish during the installation process.



NOVA 24" Cane Bolt Hardware Kit

(A0906-HDCB)

Used on double gate projects to keep one gate locked in a fixed position. Can be padlocked for safety. Stainless steel and powdercoated black. Bolt measures 24" in length.



Rail Cleaning Kit

(E0100-K001)

Clean your NOVA System with the Rail Cleaning Kit when it is dirty. Kit includes: Bottle of Car Wash Soap, MicroFiber Cloth and Cleaning Instructions.

USEFUL SPECIFICATIONS

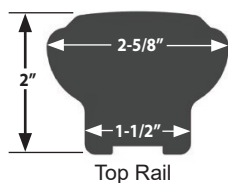

Rail Profile

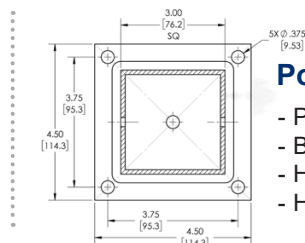

Post Details

- Post = 3"x 3"
- Base = 4.5"x 4.5"
- Hole Dia. = 3/8"
- Holes 3.75" On-Center

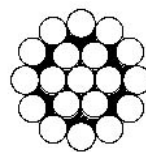

Cable Details

- 316L Stainless Steel
- 1x19, Left Hand Lay
- 1/8" Diameter