



Spectrum Gate System

Powder-Coated Stainless Steel Gate to Match the Spectrum Cable Railing System

Spectrum Gate System

The Spectrum Gate Kit is available for a 36" or 42" height Spectrum Cable Railing System. These gate kits come standard with pre-installed 1/8" or 5/32" cable and fittings. They are installer friendly and attach easily to stock Spectrum Hinge/Latch posts using the Spectrum Gate Mounting Hardware Kit (sold separately). A customer sourced hardwood flat handrail (minimum 2"x 4") is attached to the gate frame using the supplied screws. This gate is available in the standard and special Spectrum colors listed below. For use with the Spectrum System only.



SPECTRUM GATE COMPONENTS

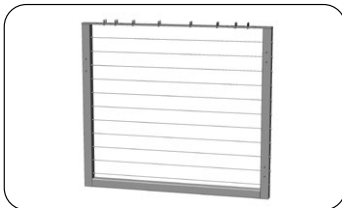

Spectrum Gate

36" Gate
(S0905-GT36-*XX03 or -*XX04)
42" Gate
(S0905-GT42-*XX03 or -*XX04)
Gate kits come standard with pre-installed cable and fittings. Through-bolt attachment allows for an easy installation on Hinge and Latch Posts.

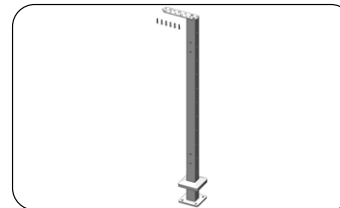

Spectrum Gate Hinge Post

36" Hinge Post (S0905-HP36*XX)
42" Hinge Post (S0905-HP42*XX)

Used on the hinge side of the Spectrum Gate and pre-drilled for standard Spectrum cable spacing and to accept hinge mounting hardware.

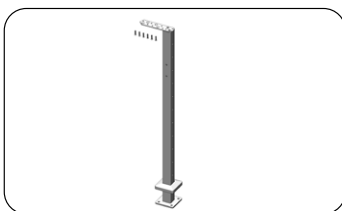

Spectrum Gate Latch Post

36" Latch Post (S0905-LP36-*XX)
42" Latch Post (S0905-LP42-*XX)

Used on the latch side of the Spectrum Gate and pre-drilled for standard Spectrum cable spacing and to accept latch mounting hardware.

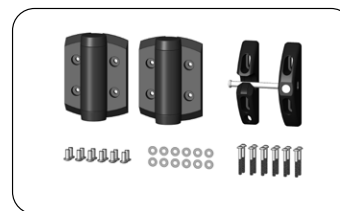

Hardware Kit, Spectrum Gate

(S0905-HDG01)

Includes everything needed to properly install a Spectrum Gate onto the Latch and Hinge Posts. Hinges and latches are made from heavy-duty polymer.

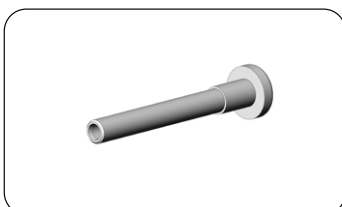

HandiSwage™ Termination Stud

(C0731-HG0703)

"Fixed" fitting used in conjunction with a HandiSwage™ Stud on the opposing end of a cable run. Flat head allows for added clearance when opening and closing the Spectrum Gate.

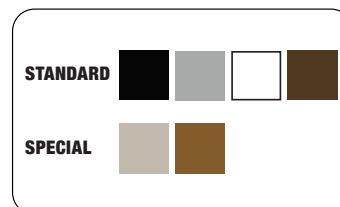

Color Selection

Colors from top, left to right:
Black, Metallic Silver, Pure White,
Dark Brown, Pebble Grey and
Light Brown.

Uncoated option available upon request.

* "XX" in the part number is the color designation. Replace with "BK" for black, "MT" for metallic silver, "WH" for white, "BR" for dark brown or "SP" for one of the special colors.

Spectrum Gate Kits Overview

Designed for use with Spectrum Rail Systems. Requires the use of a Spectrum Latch and Hinge Posts.

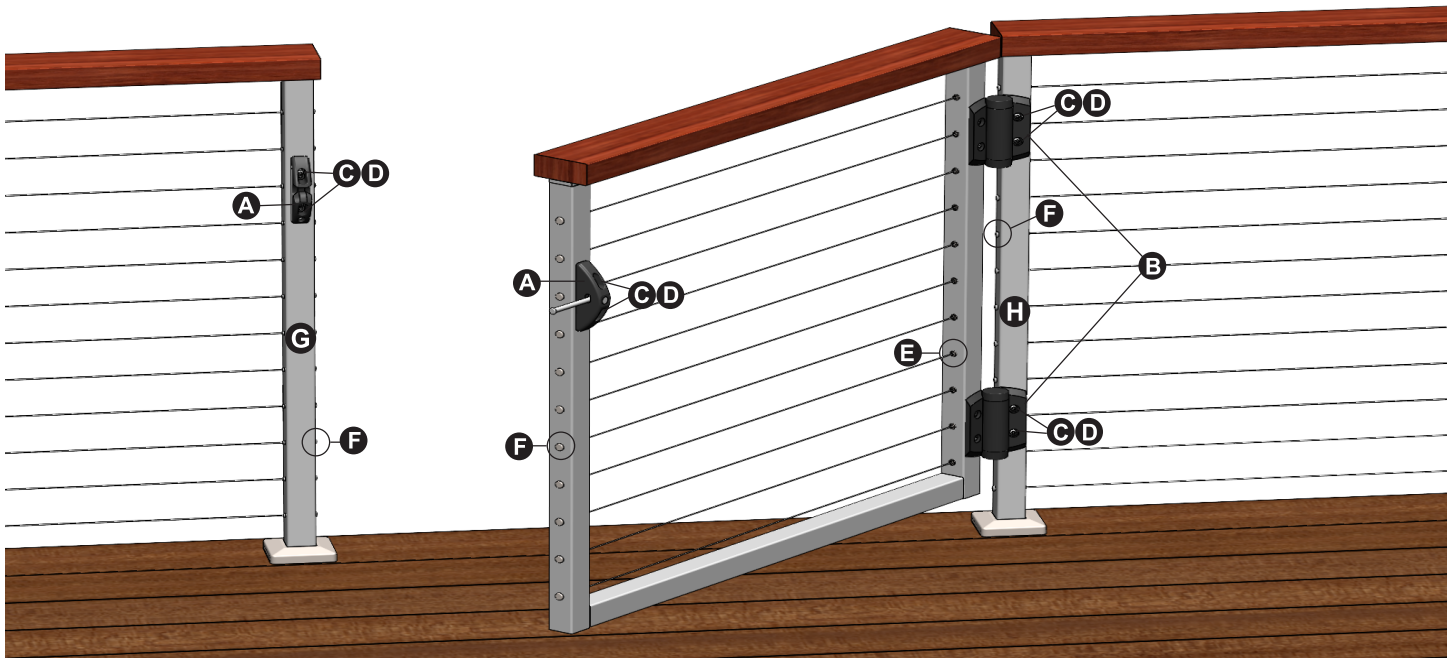

COMPONENTS

* "XX" in the part number is the color designation. Replace with "BK" for black, "MT" for metallic silver, "WH" for white, "BR" for dark brown or "SP" for one of the special colors.



Gate Latch, Black
(included in S0905-HDG01)

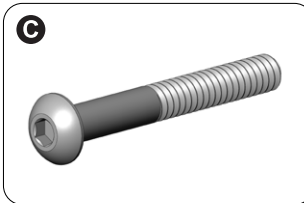

Button Head Cap Screw
(included in S0905-HDG01)

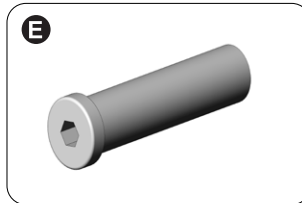

Gate Tensioner
(included in S0905-GT kits)



Gate Hinges, Black
(included in S0905-HDG01)



Barrel Nut
(included in S0905-HDG01)

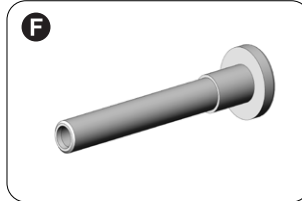

HandiSwage™ Termination Stud
(S0731-HG0703 & included in S0905-GT kits)

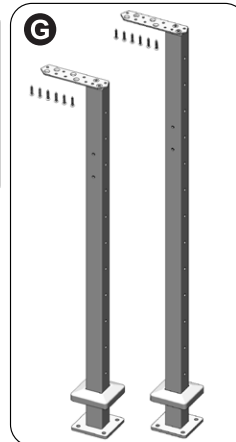

Spectrum Gate Latch Posts
36" (S0905-LP36-XX)
42" (S0905-LP42-XX)

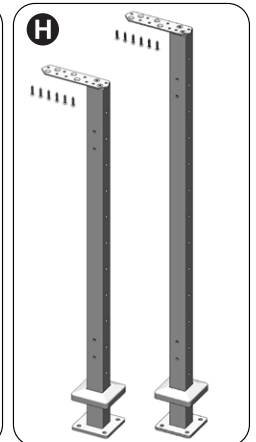

Spectrum Gate Hinge Posts
36" (S0905-HP36-XX)
42" (S0905-HP42-XX)

CONFIGURATIONS

KEY : LP = Latch Post / HP = Hinge Post

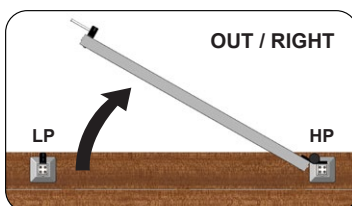

Swings OUT / Hinged RIGHT
Latch Post left, Hinge Post right
and Gate swings outward.

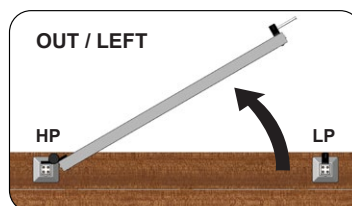

Swings OUT / Hinged LEFT
Hinge Post left, Latch Post right
and Gate swings outward.

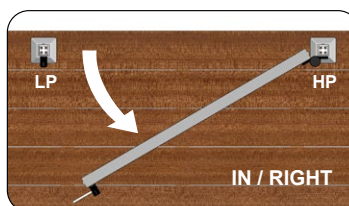

Swings IN / Hinged RIGHT
Latch Post left, Hinge Post right
and Gate swings inward.

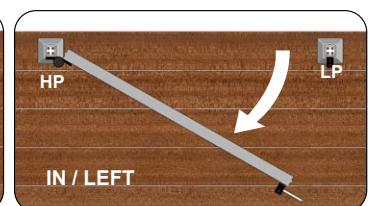

Swings IN / Hinged LEFT
Hinge Post left, Latch Post right
and Gate swings inward.