

SPECTRUM SURFACE MOUNT CABLE STABILIZER KIT

316 STAINLESS STEEL

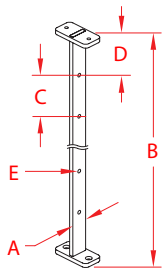
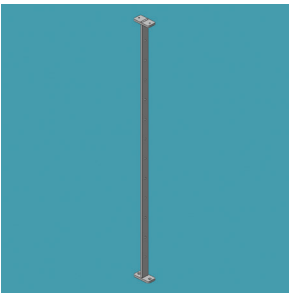

ITEM	A	B	C	D	E	WT
S0905-XX45*	1"	34.50"	2.63"	2.63"	0.22"	(lb) 2.77
S0905-XX46*	1"	40.50"	2.69"	2.69"	0.22"	3.25

NOTE:

The Spectrum Surface Mount Cable Stabilizer Kit is designed specifically for use in a Spectrum surface mounted system where post to post measurement spans over 4'. It enables you to adapt longer spans to code compliancy by stabilizing the deflection of cable between posts. Each kit comes with a pre-drilled stanchion to work with the standard spacing of the Spectrum posts. This Cable Stabilizer Kit cannot be used to replace the use of substantial mid posts and should never be used in spans over 6'. Spectrum special colors are available upon request. Kit includes fasteners.

***"XX" in the part number is the color designation. Replace with "BK" for black, "MT" for metallic silver, "WH" for white, "BR" for dark brown or "SP" for one of the special colors.*

SEE ADDITIONAL INFORMATION BELOW.

CABLE STABILIZER SAFETY INFORMATION & REQUIREMENTS

Spectrum Surface Mount Cable Stabilizers are purposed for use in maintaining code compliant cable spacing between post and rail sections with spacing greater than 4 feet between posts and not exceeding 6 feet. **The Cable Stabilizer is not a structural component and is not a substitute for a post!** Post and rail structure where a cable stabilizer is used should be rated and built to be structural without a cable stabilizer per building code requirements. Do not rely on the cable stabilizer to support the rail or add stability. The only function of the cable stabilizer is to maintain cable spacing. Building the railing to an appropriate code compliant structure is the sole responsibility of the user of Atlantis Rail products.

REQUIREMENTS & MAXIMUM LENGTHS FOR USING ATLANTIS RAIL CABLE STABILIZERS

Spectrum System: The cable stabilizer may be used with sections up to 6 feet (between posts) if all other Spectrum specifications are properly implemented.