

STAIR SPACER

316 STAINLESS STEEL

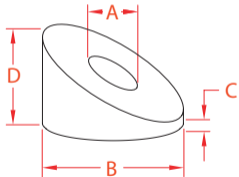

ITEM	A	DEGREE	B	C	D	QTY	WT
	(size)						(lb)
2 PACK							
C0841-0022-2	1/4"	22°	0.75"	0.05"	0.35"	2	0.07
C0841-0030-2	1/4"	30°	0.75"	0.07"	0.50"	2	0.07
C0841-0034-2	1/4"	34°	0.75"	0.004"	0.50"	2	0.07
C0841-0038-2	1/4"	38°	0.75"	N/A	0.59"	2	0.07
C0841-0041-2	1/4"	41°	0.75"	N/A	0.65"	2	0.07



NOTE:

Use in conjunction with the RailEasy™ Stud Assembly or HandiSwage™ Studs to achieve angled cable runs on stairs. Install one of our cover nut options (sold separately) on the end of the threaded stud for a finished look.