

# RAIL STAIR END CONNECTOR

316 STAINLESS STEEL

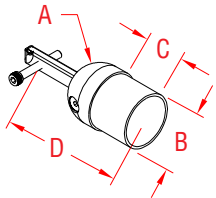

ITEM	SIZE	A	B	C	D	WT
<b>POLISHED</b>						(lb)
<b>S0950-1031</b>	2"	2.00"	1.88"	1.50"	2.95"	1.30
<b>BRUSHED</b>						
<b>S0950-1031-B</b>	2"	2.00"	1.88"	1.50"	2.95"	1.30

## NOTE:

**Patented design allows fitting to go into end posts on ramps or stairs, placing the fulcrum into the center of the post and allowing adjustment to 45 degrees up or down. Set includes one end, connecting bar and center bolt; requires special slot and rivet nut in post (supplied with complete systems).**

**The tube is placed over the end for a seamless fit. Requires rail adhesive (supplied with complete systems) to bond with tubing.**