

# RAIL ADJUSTABLE JOINT - LH

316 STAINLESS STEEL

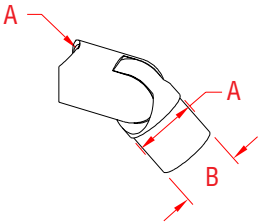

ITEM	SIZE	A	B	WT
------	------	---	---	----

(lb)

**POLISHED**

**S0950-1021**

2"

2.00"

1.88"

2.22

**BRUSHED**

**S0950-1021-B**

2"

2.00"

1.88"

2.22

**NOTE:**

**Using one LH and one RH joint for elevation changes, they are capable of abutting as close as 90 degrees and as wide as 135 degrees on the same post. Set includes pre-assembled male & female sides and the patented dovetail with a connecting bolt.**

**The tube is placed over the end for a seamless fit. Requires rail adhesive (supplied with complete systems) to bond with tubing.**

