

GLASS PANEL CONNECTOR - 1/2"

316 STAINLESS STEEL

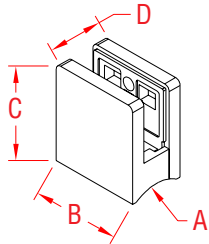

ITEM	SIZE	A	B	C	D	WT
------	------	---	---	---	---	----

(lb)

POLISHED

S0950-0008	2"	2.00"	2.13"	2.33"	3/8"-1/2"	1.00
-------------------	----	-------	-------	-------	-----------	------

BRUSHED

S0950-0008-B	2"	2.00"	2.13"	2.33"	3/8"-1/2"	1.00
---------------------	----	-------	-------	-------	-----------	------

NOTE:

Heavy duty version used for 3/8" to 1/2" thick glass. Connector back is specially shaped to fit the outside of 2" tubing and attached by a screw into a rivet nut placed into the tubing (both not included); bolt and rivet are hidden by the connector.

Connector opens on one side after installation to allow glass to be positioned between neoprene pads (included). Rivets and fixing screws are supplied with complete rail systems.