

RAIL BASE- END SHIM

316 STAINLESS STEEL

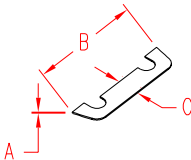

ITEM

A

B

C

WT

(lb)

S0950-EH04

0.03"

2.75"

0.50"

0.01

NOTE:

END SHIM IS USED UNDER THE END OF A RAIL MOUNTING BASE (S0950-0001 OR S0950-0003) IF MOUNTING SURFACE IS UNEVEN. THE END SHIM IS DESIGNED TO HAVE THE SAME PROFILE AS THE END OF RAIL BASE FOR A SEAMLESS APPEARANCE.