

# RAIL STAIR DBL CONNECTOR

316 STAINLESS STEEL

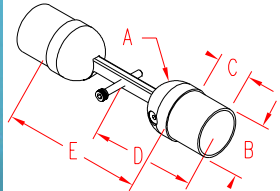

ITEM

SIZE

A

B

C

D

E

WT

**POLISHED**

**S0950-1030**

2"

2.00"

1.88"

1.50"

2.95"

5.90"

2.72

**BRUSHED**

**S0950-1030-B**

2"

2.00"

1.88"

1.50"

2.95"

5.90"

2.72

**NOTE:**

**PATENTED DESIGN ALLOWS FITTING TO GO THROUGH INTERMEDIATE POSTS ON RAMPS OR STAIRS, PLACING THE FULCRUM INTO THE CENTER OF THE POST AND ALLOWING ADJUSTMENT TO 45 DEGREES UP OR DOWN. SET INCLUDES TWO ENDS, "CONNECTING BAR" AND CENTER BOLT; REQUIRES SPECIAL SLOTS AND RIVET NUTS IN POST (SUPPLIED WITH COMPLETE SYSTEM).**

**THE TUBE IS PLACED OVER THE END FOR A SEAMLESS FIT; REQUIRES SPECIAL EPOXY (SUPPLIED WITH COMPLETE SYSTEMS) TO BOND WITH TUBING.**

