

RAIL MID SUPPORT

316 STAINLESS STEEL

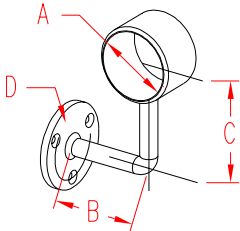

ITEM

SIZE

A

B

C

D

FAST.

WT

(lb)

POLISHED

S0902-0401

2"

2.02"

2.75"

3.38"

1.88"

#10

0.80

BRUSHED

S0902-0401-B

2"

2.02"

2.75"

3.38"

1.88"

#10

0.80

NOTE:

THIS IS A ONE PIECE MID SUPPORT WITH FLAT MOUNTING PLATE, DESIGNED FOR CONTINUOUS 2" WALL MOUNTED HANDRAILS. LENGTH OF TUBING CAN BE JOINED INSIDE THE SUPPORT BY ADDING A "RAIL CONNECTOR" (PAGE 43), WHICH MAKES SUCH JOINT INVISIBLE. SUPPORT IS MOUNTED USING THREE #10 WOOD SCREW FASTENERS (NOT SUPPLIED).