

# RAIL CENTER GUIDE

**316 STAINLESS STEEL**

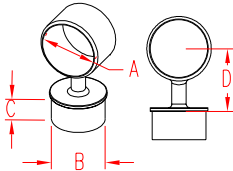

ITEM	SIZE	A	B	C	D	WT
------	------	---	---	---	---	----

(lb)

**POLISHED**

**S0902-0305**

2"

2.02"

1.88"

1.00"

2.20"

0.65

**BRUSHED**

**S0902-0305-B**

2"

2.02"

1.88"

1.00"

2.20"

0.65

**NOTE:**

**THIS GUIDE ALLOWS A CONTINUOUS 2" HANDRAIL TO BE PLACED ON TOP OF A VERTICAL 2" TUBULAR POST. LENGTH OF TUBING CAN BE JOINED INSIDE THE GUIDE BY USING A "RAIL CONNECTOR" (PAGE 43), WHICH MAKES SUCH JOINT INVISIBLE. TO SECURE THE GUIDE TO THE 2" TUBULAR POST, USE THE SPECIAL EPOXY (SUPPLIED WITH COMPLETE SYSTEMS).**