

# RAIL KNUCKLE JOINT

**316 STAINLESS STEEL**

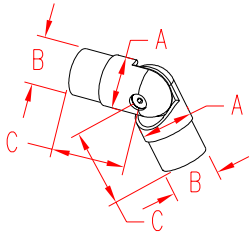

**ITEM**

**SIZE**

**A**

**B**

**C**

**WT**

(lb)

***POLISHED***

**S0901-1408**

1-1/2"

1.50"

1.38"

2.25"

0.87

***BRUSHED***

**S0901-1408-B**

1-1/2"

1.50"

1.38"

2.25"

0.87

***NOTE:***

***PATENTED RAIL KNUCKLE JOINT IS USED IN 1-1/2" HANDRAIL APPLICATIONS. THIS ADJUSTABLE FITTING IS UTILIZED IN STAIR AND RAMP APPLICATIONS.***

