

STAINLESS TUBING

316 STAINLESS STEEL

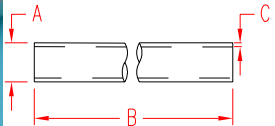
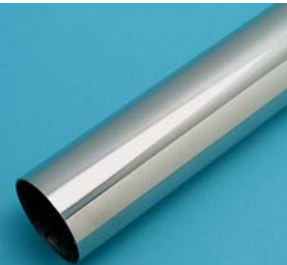

ITEM	SIZE	A	B	C	WT (lb)
<i>POLISHED- BY THE FOOT</i>					
S0900-0022	7/8"	0.88"	12.00"	0.062"	0.56
S0900-0025	1"	1.00"	12.00"	0.062"	0.65
S0900-0038	1-1/2"	1.50"	12.00"	0.062"	0.85
S0900-0050	2"	2.00"	12.00"	0.062"	1.34
<i>POLISHED- STANDARD LENGTHS</i>					
S0950-0034	2"x4'	2"	48.00"	0.062"	5.36
S0950-0035	2"x5'	2"	60.00"	0.062"	6.70
<i>BRUSHED- BY THE FOOT</i>					
S0900-B038	1-1/2"	1.50"	12.00"	0.062"	0.85
S0900-B050	2"	2.00"	12.00"	0.062"	1.34